

## TO PLAY

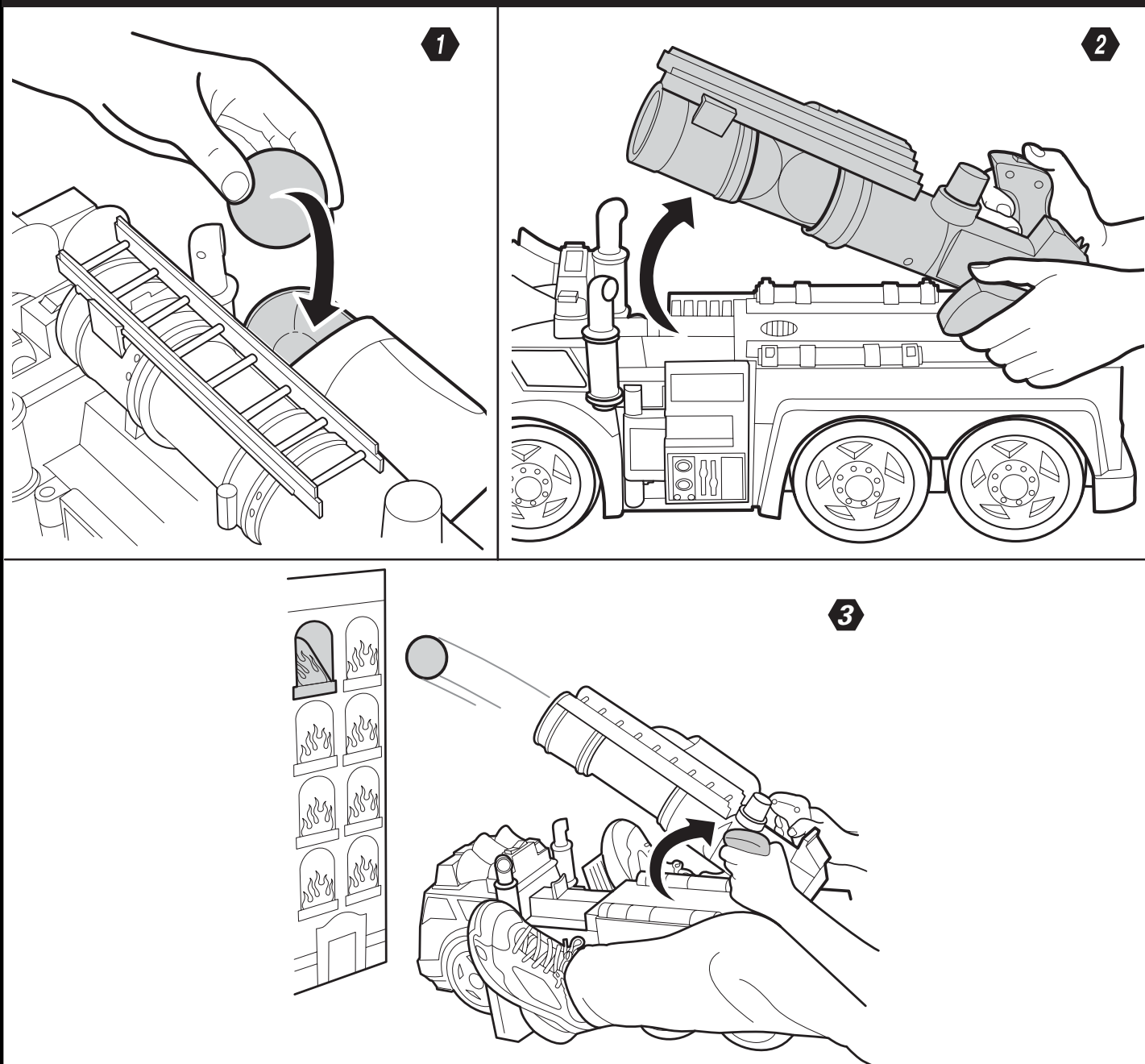

## BATTERY SAFETY INFORMATION

Batteries may leak fluids that can cause a chemical burn injury or ruin your toy (product). To avoid battery leakage:

- Do not mix old and new batteries or batteries of different types: alkaline, standard (carbon-zinc) or rechargeable (nickel-cadmium).
- Insert batteries as indicated inside the battery compartment.
- Remove batteries during long periods of non-use. Always remove exhausted batteries from the toy (product). Dispose of batteries safely. Do not dispose of batteries in a fire. The batteries may explode or leak.
- Never short-circuit the battery terminals.
- Use only batteries of the same or equivalent type, as recommended.
- Do not charge non-rechargeable batteries.
- Remove rechargeable batteries from the toy (product) before charging.
- If removable, rechargeable batteries are used; they are only to be charged under adult supervision.



**WARNING:**  
**CHOKING HAZARD** - Toy contains  
 small balls and small parts. Not for  
 children under 3 years.



• Toy Contains Small Balls/Small Parts.

• Keep these instructions for future use; they contain important information.

## BATTERY REPLACEMENT

- **CLEANING** Brush away loose dirt, then wipe with a damp cloth. DO NOT IMMERSE IN WATER.
- Batteries included are for demonstration purposes only.
- If sound distorts, or light dims, replace batteries.
- Unscrew and remove the battery cover. Remove the old batteries and dispose of them safely.
- Insert 3 new "AA" (LR6) batteries as shown in the diagram. Alkaline batteries provide best results.
- Make sure that polarity is correct.
- Replace the battery cover and its screw.

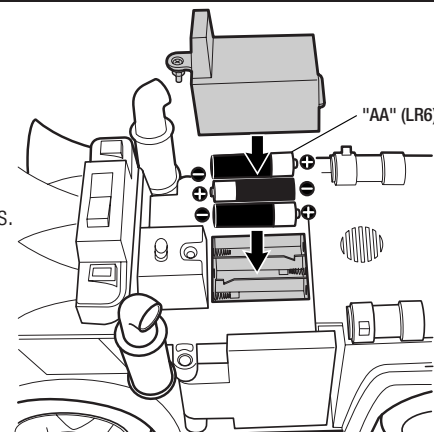

## OPERATION

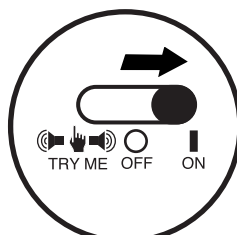
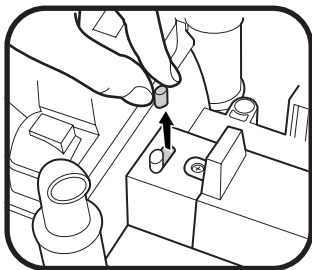

Turn to ON position.

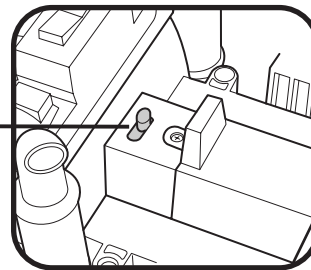

**Normal Play:** Slide switch to "ON" position instead of "TRY ME" position after unpacking the toy to play in full function.

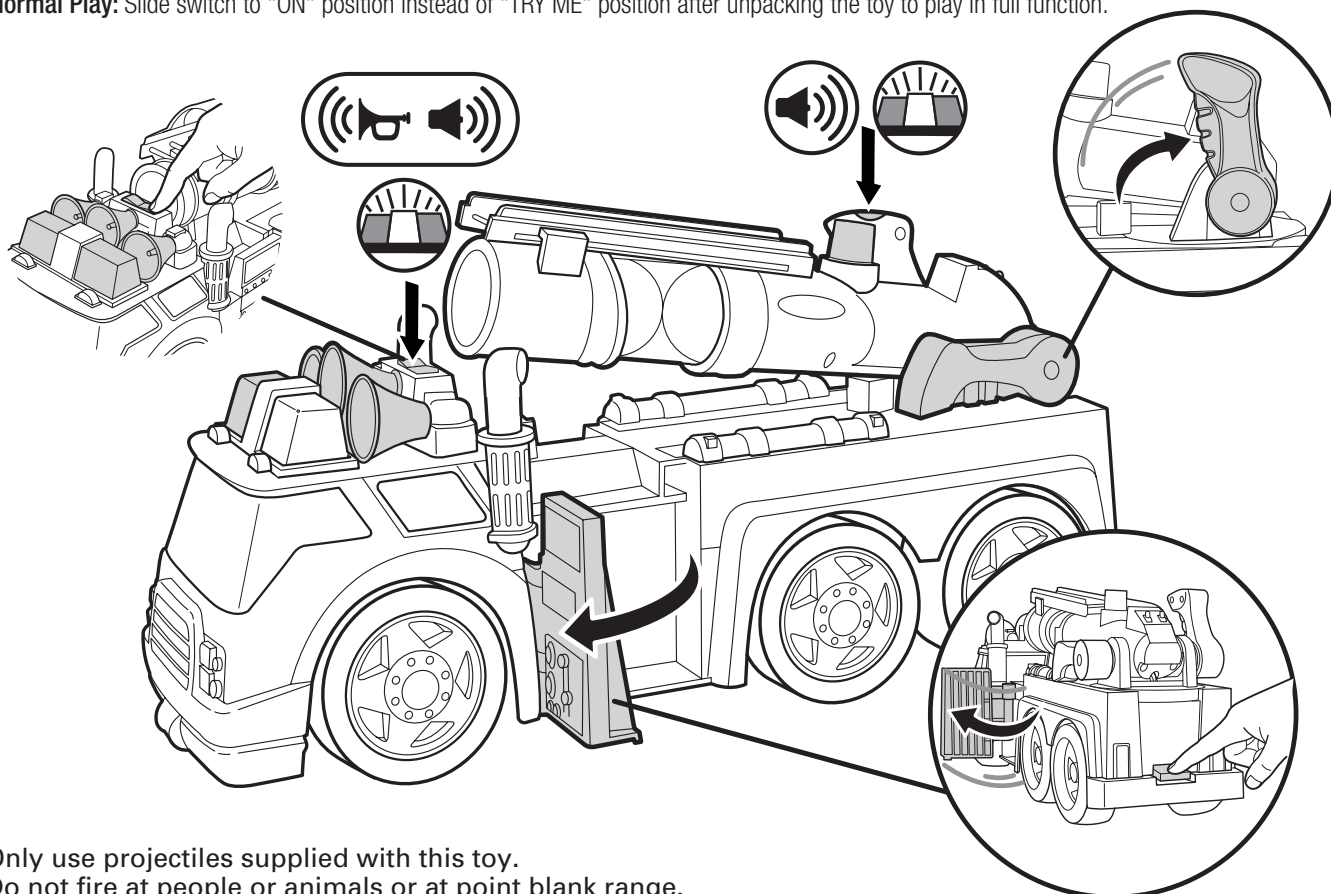

Only use projectiles supplied with this toy.  
 Do not fire at people or animals or at point blank range.